

# Inductive ring sensor

## RC10-14-N0-Y95902

- 10 mm inside diameter
- Comfort series



### Dimensions

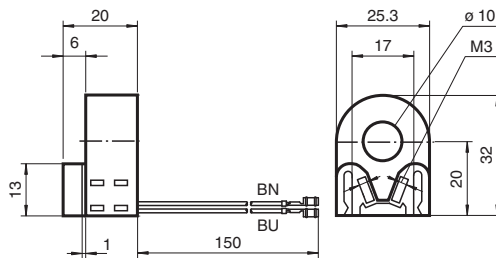

### Technical Data

#### General specifications

Switching function	Normally closed (NC)
Output type	NAMUR
Inside diameter	10 mm
Measuring cone	4 mm, 1.4305 / AISI 303
Output type	2-wire

#### Nominal ratings

Nominal voltage	$U_o$	8 V
Operating voltage	$U_B$	5 ... 25 V
Switching frequency	f	0 ... 2000 Hz
Current consumption		
Measuring plate not detected		min. 3 mA at maximum permissible ambient temperature, the current consumption can drop to 1.6 mA
Measuring plate detected		$\leq 1$ mA

#### Functional safety related parameters

MTTF <sub>d</sub>	6150 a
Mission Time (T <sub>M</sub> )	20 a
Diagnostic Coverage (DC)	0 %

#### Compliance with standards and directives

Standard conformity	
NAMUR	EN 60947-5-6:2000 IEC 60947-5-6:1999
Standards	EN 60947-5-2:2007 EN 60947-5-2/A1:2012 IEC 60947-5-2:2007 IEC 60947-5-2 AMD 1:2012

#### Approvals and certificates

ATEX approval	
Equipment protection level Gb	PTB 99 ATEX 2128 X
UL approval	cULus Listed, General Purpose

Release date: 2023-01-27 Date of issue: 2023-01-27 Filename: 095902\_eng.pdf

Refer to "General Notes Relating to Pepperl+Fuchs Product Information".

Pepperl+Fuchs Group  
www.pepperl-fuchs.com

USA: +1 330 486 0001  
fa-info@us.pepperl-fuchs.com

Germany: +49 621 776 1111  
fa-info@de.pepperl-fuchs.com

Singapore: +65 6779 9091  
fa-info@sg.pepperl-fuchs.com

**PEPPERL+FUCHS**

## Technical Data

CSA approval	cCSAus Listed, General Purpose
<b>Ambient conditions</b>	
Ambient temperature	-20 ... 65 °C (-4 ... 149 °F)
Storage temperature	-40 ... 100 °C (-40 ... 212 °F)
<b>Mechanical specifications</b>	
Connection type	cable PVC , 150 mm Crimp terminal sockets 60888-3, AMP
Core cross section	0.14 mm <sup>2</sup>
Housing material	PBT
Degree of protection	IP67
Mass	18 g
<b>General information</b>	
Use in the hazardous area	see instruction manuals

## Connection

